

# HEXT

HANDLES. WITH CARE.



 **COMUNELLO**

## Serie 2600



INOX  
lucido / polished

INOX  
satinato / satin

ALLUMINIO/ALUMINIUM  
anodizzato satinato  
anodized satin

ALLUMINIO/ALUMINIUM  
nero / black  
RAL 9005



Fissaggi pag. 72  
Fixings page 72  
Fijaciones página 72  
Befestigung seite 72  
Элементы крепления страница 72

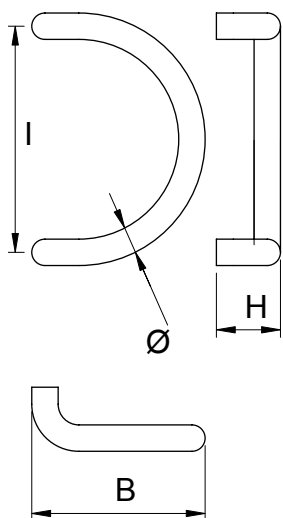

### 2600 INOX 316L lucido / polished

010				Ø	I	H	B		
N260D001XB009	<b>2-6165-009</b>	316L	lucido / polished	30	300	85	225	2	1.78
N260D002XB009	<b>2-6167-009</b>	316L	lucido / polished	30	350	85	245	2	1.96
N260E001XB009	<b>2-6183-009</b>	316L	lucido / polished	35	300	85	230	2	2.05
N260E002XB009	<b>2-6185-009</b>	316L	lucido / polished	35	350	85	260	2	2.31

### 2600 INOX 316L satinato / satin

010				Ø	I	H	B		
N260D001XB010	<b>2-6165-010</b>	316L	satinato / satin	30	300	85	225	2	1.78
N260D002XB010	<b>2-6167-010</b>	316L	satinato / satin	30	350	85	245	2	1.96
N260E001XB010	<b>2-6183-010</b>	316L	satinato / satin	35	300	85	230	2	2.05
N260E002XB010	<b>2-6185-010</b>	316L	satinato / satin	35	350	85	260	2	2.31

### 2600 INOX 304

010				Ø	I	H	B		
N260D902XB010	<b>2-6167E-010</b>	304	satinato / satin	30	350	85	245	2	1.96

### 2600 AL

010				Ø	I	H	B		
M260D001XA503	<b>2-6765-503</b>	AL	nero / black	30	300	85	225	2	1.16
M260D001XA604	<b>2-6765-604</b>	AL	anodizzato / anodized	30	300	85	225	2	1.16
M260D002XA503	<b>2-6767-503</b>	AL	nero / black	30	350	85	245	2	1.28
M260D002XA604	<b>2-6767-604</b>	AL	anodizzato / anodized	30	350	85	245	2	1.28
M260E001XA503	<b>2-6783-503</b>	AL	nero / black	35	300	85	230	2	1.49
M260E001XA604	<b>2-6783-604</b>	AL	anodizzato / anodized	35	300	85	230	2	1.49
M260E002XA503	<b>2-6785-503</b>	AL	nero / black	35	350	85	260	2	1.68
M260E002XA604	<b>2-6785-604</b>	AL	anodizzato / anodized	35	350	85	260	2	1.68

HEXT

[www.comunello.com/hext](http://www.comunello.com/hext)